



LED TAIL STROBE & POSITION LIGHT 28V P/N 6482601

MAIN FEATURES - Aviation Tail Strobe/Position Light CS25 Certified (Dassault Aviation F900 & F2000)

•Reliability

Led Position Light : 20 000 H

Led strobe light : 20 000 H

•Low weight

•Resistance to high vibrations

•Tested for extreme environment

Dassault Aviation EGS / DGT-DTF/SYS/AV 69706

TECHNICAL FEATURES

Position Light: Voltage : 28VDC - DO160D cat Z

Power: 2 W

Color: Aviation white

Strobe light: Power: 60W

Light energy:: > to 400 cd with PSU P/N 6482702

Color: Aviation white

•Operating Temperature :

55°C / +70°C

• Connecting:

HE302 17R 14B-12-PNH

- A: Input + 28 V Position light

- B: Input 0 V Position light

- C: not connected

- D: Mechanical ground

- E: Mechanical ground

- J: + Input Strobe

- K: - Input Strobe

- L&M: not connected

•**Altitude :** + 55000 ft

•**Weight :** 650 grs (1.44 lbs)

CONTACTS

•**Phone:** +33 (0)380 356 390,

•**Email:** jpc@jpcaviation.com - **Website:** www.jpcaviation.com

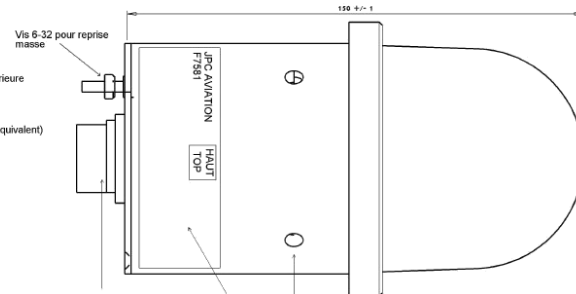
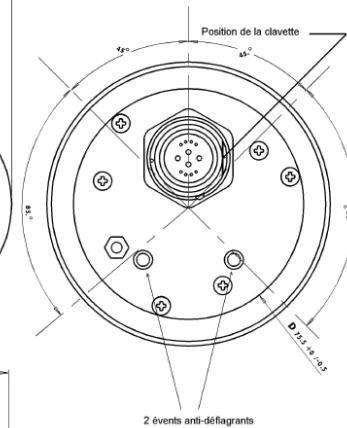
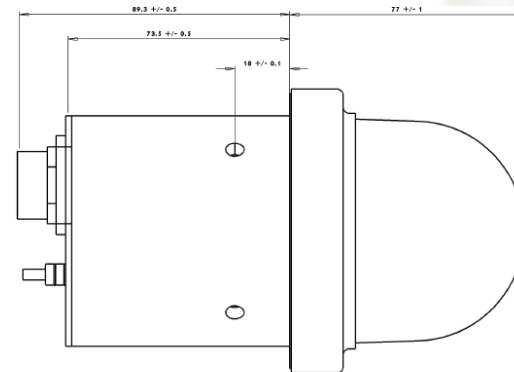
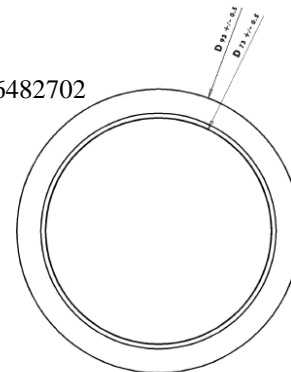

Matériau : Aluminium AU4G
Traitements : Anodine A 1200 - Peinture blanche partie extérieure
Masse : 650 g +/- 5 %
Alimentation feu position : 28V DC
Courant feu position : 70 mA +/- 10 %
Température de fonctionnement : - 55 °C / + 70 °C
Connecteur : HE 302 - 8525-17R14B12PNH (Souriau or equivalent)
Pin A : + 28V LED Position Light
Pin B : GND
Pin C : Not used
Pin D : Ground
Pin E : Ground
Pin F : Not used
Pin G : Not used
Pin H : Not used
Pin J : + White LED
Pin K : - White LED
Pin L : Not used
Pin M : Not used

Position de la clavette
Etiquette d'identification

4 trou de fixation 6-32
Pénétration des vis 10 mm max